



Programme  
30th Annual Meeting of the  
Canadian Association for Physical Anthropology  
Ottawa, Ontario 2002



Programme  
30ième réunion annuel de  
L'Association canadienne pour l'anthropologie physique  
Ottawa, Ontario 2002

Hôtel Crowne Plaza Hotel  
Ottawa, Ontario  
October 24-26, 2002

**2002 Executive of the CAPA  
Conseil d'administration de l'ACAP, 2002**

**President / Président : Richard Lazenby  
President-Elect / Président-élu : Andrew Nelson  
Secretary-Treasurer / Secrétaire-trésorière : Anne Zeller**

**2002 Managing Officers of the CAPA  
Gestionnaires de l'ACAP**

**Newsletter Editor / Responsable du bulletin d'information : Rob Hoppa  
Webmaster / Responsable de la page web : Leslie Chan**

**2002 Conference Organizing Committee  
Comité organisateur 2002**

**Conference Chair / Président du congrès : Jerome Cybulski  
Scientific Programme Chair / Présidente du programme scientifique : Janet Young  
Registration and Volunteers / Responsable de l'inscription et bénévoles : Stacey Girling-Christie  
Conference Treasurer / Trésorier : Lyle Henderson  
Hospitality / Responsable de l'accueil : Karen Albright Murchison  
Web Site / Responsable de la page web : Jean-Luc Pilon  
Translation Assistance / Assistance à la traduction : Lucie Johannis  
Audio-visual / Responsable de l'audio-visuel : David Keenlyside**

## **Welcome**

On behalf of the CAPA executive, conference organizers and this year's host, the Archaeological Survey of Canada, Canadian Museum of Civilization, I welcome you to our 30<sup>th</sup> annual conference. The Crowne Plaza Hotel staff and conveners sincerely hope your stay is enjoyable as well as productive. We have lots of events planned and you are in the Nation's Capital during the best time of the year for sunshine and fall colours. We have over 70 scientific presentations, 10 sessions and one workshop, possibly an all time record. We apologize to those whose submissions could not be accepted due to an overwhelming response from our membership. Please do enjoy your stay with us!

Jerome Cybulski  
Conference Chair

## **Accueil**

Au nom de l'Exécutif de l'ACAP, du comité organisateur, de la Commission archéologique du Canada et du Musée canadien des civilisations je suis heureux de vous accueillir à notre 30<sup>ième</sup> congrès annuel. Vos hôtes ainsi que l'Hôtel Crowne Plaza souhaitent que votre séjour s'avère tout aussi agréable que productif. Nous avons planifié plusieurs activités et vous avez la chance de vous trouver dans la région de la capitale nationale lorsque le coloris automnale est à l'apogée de sa splendeur. Nous battons tous les records avec plus de soixante-dix communications scientifiques, dix symposiums et un atelier. La réponse de nos membres fut si grande que nous étions dans l'impossibilité d'accepter toutes les communications soumises et nous nous en excusons auprès de tout ceux et celles dont les communications n'ont pas été retenues. Nous vous souhaitons un agréable séjour parmi nous !

Jerome Cybulski  
Président du congrès

## CONTENTS

<b>Events .....</b>	<b>2</b>
<b>Meeting Rooms .....</b>	<b>4</b>
<b>Session 1</b>	
<b>Personal Identification in Forensic Anthropology .....</b>	<b>6</b>
<b>Session 2</b>	
<b>Contributed Papers .....</b>	<b>8</b>
<b>Session 3</b>	
<b>Doing Biocultural Anthropology .....</b>	<b>12</b>
<b>Session 4</b>	
<b>Mummy Studies .....</b>	<b>14</b>
<b>Session 5</b>	
<b>4-D Paleoanthropology: Applications of Digital Morphometrics, Computer-aided Systematics and Geographical Information Systems Analysis to the Study of Great Ape and Human Origins .....</b>	<b>16</b>
<b>Workshop</b>	
<b>Teaching Physical Anthropology: A Workshop on Teaching Strategies and Tricks of the Trade .....</b>	<b>18</b>
<b>Session 6</b>	
<b>Digital Imaging in Bioarchaeology: New Concepts and Approaches .....</b>	<b>20</b>
<b>Session 7</b>	
<b>Hard Tissue Studies at the Molecular, Microscopic and Chemical Levels .....</b>	<b>22</b>
<b>Session 8</b>	
<b>Food for Thought: Studies of Diet and Nutrition in Physical Anthropology .....</b>	<b>24</b>
<b>Session 9</b>	
<b>The Contribution and/or Confusion, of Incorporating More Culturally Sensitive Data Sources with Osteology Research .....</b>	<b>26</b>
<b>Session 10</b>	
<b>Primate Behaviour .....</b>	<b>28</b>
<b>Posters .....</b>	<b>29</b>
<b>Sponsors .....</b>	<b>30</b>

## **EVENTS**

### **Social Events**

**Reception** : A cash-bar reception will be held on Thursday night from 7:30 p.m. until 10 p.m. in the Panorama Lounge. Our sponsor for the evening is the Archaeological Survey of Canada of the Canadian Museum of Civilization.

**Banquet** : Our Banquet will be held Friday night with a cash bar starting at 7:00 p.m. and dinner at 7:30 p.m. in the Panorama Lounge of the Crowne Plaza Hotel. Our Banquet Guest Speaker will be Patricia Sutherland of the Canadian Museum of Civilization's Hurland Archaeological Project. Her topic: "A New Perspective on Native-Norse Contact in North America".

### **Other Events**

**Silent Auction** : A silent auction will be held on Thursday and Friday with the winners being announced at the banquet on Friday night. Items to be auctioned have been donated by various conference sponsors. The money raised will be put towards conference costs. Support your organization by bidding and purchasing something!!



# Meeting Rooms

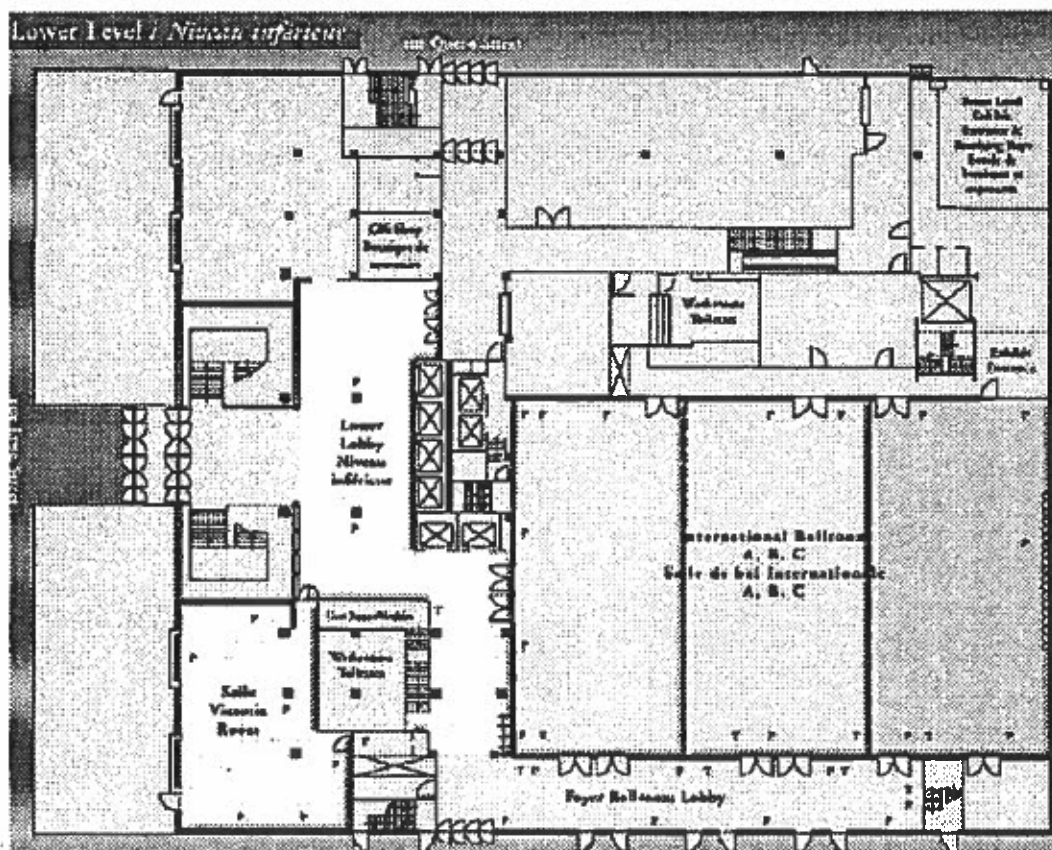
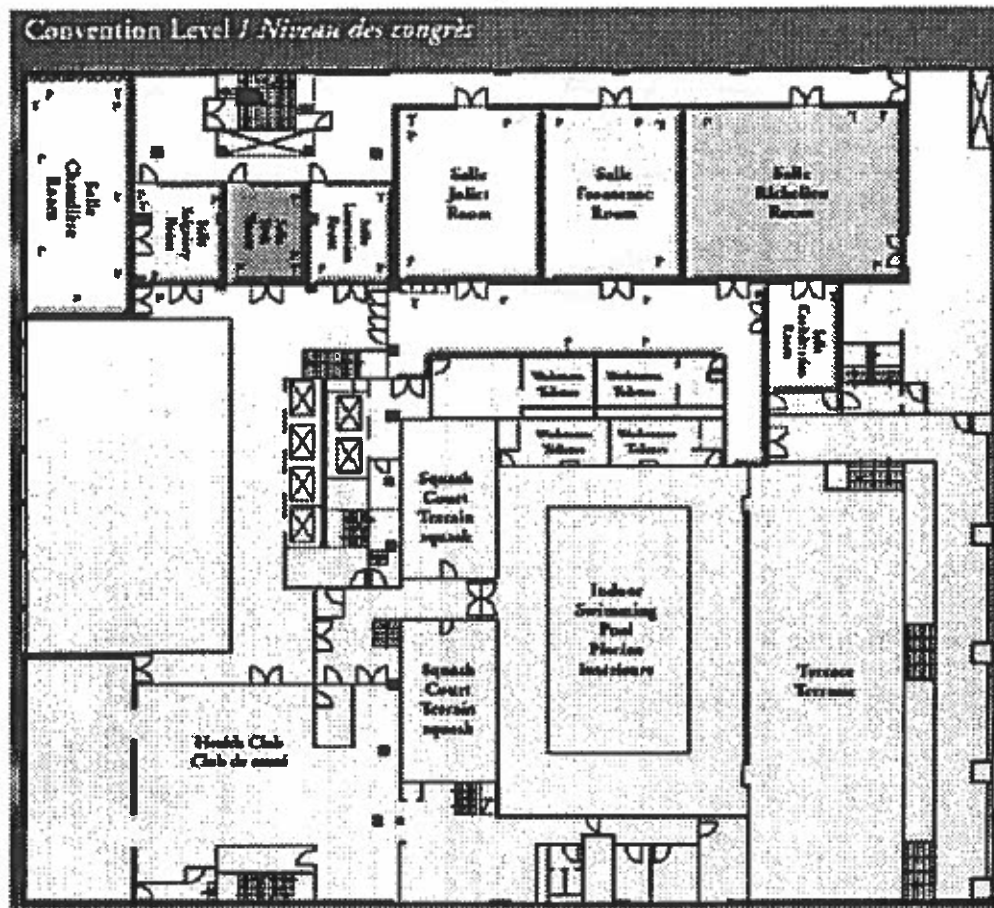

## NOTES

***Programme académique/Academic Programme***  
***Thursday/Jeudi 8:00am-10:30am***

---

**Session 1**

**Personal Identification in Forensic Anthropology**

Présidente/Chair: Tracy Rogers, University of Toronto

---

- 8:00-8:15**     **Introductory Remarks**  
(Tracy Rogers, University of Toronto)
- 8:15-8:45**     **The Importance of Positive Identification: The Lengths and Depths of the Vancouver Missing Women Task Force Excavation**  
(Cpl. Mike Coyle and Cst. Dan Almas, RCMP, Missing Women Task Force)
- 8:45-9:00**     **A test of the Milner-Boldsen Method and Transition Analysis on Known Age Modern and Archaeological Pubes**  
(M. Sitchon and R.D. Hoppa, University of Manitoba and S.R. Saunders, McMaster University)
- 9:00-9:15**     **A New Metric Sex Determination Method Using the Clavicle and Humerus**  
\*(John Albanese, McMaster University)
- 9:15-9:30**     **Facial Reconstruction Using Clay and Other Techniques**  
(Peter Petersen)
- 9:30-9:45**     **Creating A Mathematical Representation of Cranial Suture Patterns: For Use in Identification of Unknown Decedents**  
\*(Travis Allard, RCMP, Missing Women Task Force Excavation Team)
- 9:45-10:00**    **The Felon and the Prenologist: The Forensic Identification of an Executed Felon**  
(Michael W. Spence, University of Western Ontario)
- 10:00-10:15**   **Levels of Certainty in Positive Identification**  
(Tracy Rogers, University of Toronto)
- 10:15-10:30**   **Break**



## NOTES

**Programme académique/Academic Programme**  
**Thursday/Jeudi (10:30am-1:30pm)**

---

**Session 2**

**Contributive Papers**

Présidente/Chair: Lynda Wood, Natural Sciences and Engineering Research Council of Canada

---

**10:30-10:45** **Introductory Remarks**

**10:45-11:00** **Mechanisms for the Accumulation of Metals In Human Hair from an Archaeological Context: Studies Using Ultra-Trace Analysis**  
(R. Martin, A.J. Nelson, M. Beisinger and S.J. Naftel, University of Western Ontario and I.M. Kempson and W.M. Skinner, University of South Australia) *Time of Flight Scanning EM (TIF SIMS)*

**11:00-11:15** **Patterns of Long Bone Trauma in the W.S. Webb Skeletal Sample from Indian Knoll, Kentucky** *sex at < 17 yr How can M-F be signif. if pattern are random? ( $\chi^2$ )*  
\*(Bonnie Glencross, University of Toronto)

**11:15-11:30** **Bones and Ball Fields: The Forgotten Cemetery of St. Vital** *Battleford, Sask.*  
(1879-1889) *Hopkins*  
(Colette Gauthier and Treena Swanston, University of Saskatchewan)

**11:30-11:45** **Accounting for Variability in Musculoskeletal Stress Marker (MSM) Studies: The Effects of Body Height, Robusticity, and Population Characteristics on Enthesial Development** *correlation/causation*  
\*(Jennifer Nash, University of Western Ontario)

*♂ ~ ♀*  
*Hockey method*

**11:45-12:00** **Humeral Cross-Sectional Morphology from 18th Century Quebec Prisoners of War: Activity Pattern or Biology?**  
(Elizabeth Weiss, University of Arkansas) *ack. Steve Churchill*

*Maxwell Museum "NM suburbanites" early 20th C, N=27♂*

**12:00-1:30** **Lunch**

## NOTES

***Programme académique/Academic Programme***  
***Thursday/Jeudi (1:30pm-3:30pm)***

---

**Session 2 (Cont'd)**

**Contributive Papers**

**Présidente/Chair:** Lynda Wood, Natural Sciences and Engineering Research Council of Canada

---

- 1:30-1:45      Piecing Together the Mortuary Program of the Ontario Middle Woodland Hopewellian Manifestation at Cameron's Point**  
**\* (Kate Dougherty, University of Western Ontario)**
- 1:45-2:00      A Methodology for the Development of Univariante Sectioning Points for Skeletal Sex Determination and Their Uses in Fieldwork**  
**\* (Hugo Cardoso, Museu Nacional de História Natural)**
- 2:00-2:15      A Morphometric and Radiographic Study of the Effects of Hybridization Patterns of Craniofacial Growth Allometry Among the Macaques of Sulawesi**  
**(Michael Schillaci, University of New Mexico)**
- 2:15-2:30      The Relationship Between Molar Wear and Caries Frequency in Two Postclassic Maya Skeletal Populations**  
**\* (Julianna Matthews, University of Western Ontario)**
- 2:30-2:45      Addressing Issues of Selective Mortality in Skeletal Populations Using Indicators of Iron Deficiency Anemia**  
**\* (Jay Maxwell, University of Western Ontario)**
- 2:45-3:00      Atresia of the External Auditory Meatus: A Case from a Late 19th Century Cemetery**  
**(Treena Swanston and Ernest G. Walker, University of Saskatchewan)**
- 3:00-3:15      Fraud and Fallacy in Physical Anthropology: A Look at Problems of Misrepresentation in the Twentieth Century**  
**(Gary S. Tait)**
- 3:15-3:30      Break**

## NOTES

***Programme académique/Academic Programme***  
***Thursday/Jeudi (3:30pm-6:00pm)***

---

**Session 3**

**Doing Biocultural Anthropology**

Présidente/Chair: Alexis Dolphin, University of Massachusetts

---

- 3:30-3:45**      **Introductory Remarks**  
(Alexis Dolphin, University of Massachusetts and Joseph M. Parish,  
University of Missouri)
- 3:45-4:00**      **The Necessity of a Holistic Biocultural Approach to Epidemiologic  
Studies in Anthropology**  
\*(Joseph M. Parish, University of Missouri)
- 4:00-4:15**      **Two Different Worlds: Infant Mortality as a Proxy Measure of the  
Health Experience in the Maltese Islands**  
(Larry Sawchuk, Stacie D.A. Burke, Leah Walz, and Janet Padiak,  
University of Toronto)
- 4:15-4:30**      **Doing Biocultural Anthropology: The View from Cross-Cultural  
Mental Health**  
(Joseph K. So, Trent University)
- 4:30-4:45**      **Testing the Ethnohistoric Record with Biological Expectations. An  
Example from Northern Peru**  
\*(J. Marla Toyne, Tulane University)
- 4:45-5:00**      **Urbanization, Immigration and Ethnicity at Teotihuacan: An  
Ancient Model for Modern Cities**  
(Christine D. White, University of Western Ontario; Rebecca Storey,  
University of Houston; Fred J. Longstaffe and Michael W. Spence,  
University of Western Ontario)
- 5:00-5:15**      **The Teeth that Bind: Estimating African Natality at the New York  
African Burial Ground by Elemental Signature Analysis**  
(Joseph L. Jones, University of Massachusetts; Alan H. Goodman, John  
Reid and Dulasiri Amarasiriwardena, Hampshire College; Mark E. Mack,  
Howard University; and Michael L. Blakey, College of William and Mary)
- 5:15-5:30**      **Beautiful Ideals: A Biocultural Approach to the Body and its  
Modification**  
\*(Alexis Dolphin, University of Massachusetts)
- 5:30-5:45**      **Doing Biocultural Anthropology: Easier Said Than Done**  
(Ann Herring and Tina Moffat, McMaster University)
- 5:45-6:00**      **Discussant**



## NOTES

***Programme académique/Academic Programme***  
***Friday/Vendredi 8:00am-9:30am***

---

**Session 4**

**Mummy Studies**

**Présidente/Chair: Heather Gill-Robinson, University of Manitoba**

---

- |                  |   |
|------------------|---|
| <b>8:00-8:15</b> | <b>Introductory Remarks</b>   |
| <b>8:15-8:30</b> | <b>Mummies in Manitoba? Initial Report on the Remains of Two Partially Mummified Sub-adults from Western Manitoba</b><br><b>*(Barbara Hewitt, University of Manitoba)</b>   |
| <b>8:30-8:45</b> | <b>DNA from Mummified Remains</b><br><b>*(C.D. Matheson, Lakehead University)</b>   |
| <b>8:45-9:00</b> | <b>Misplaced Mummies: Employment of Non-Destructive Methods from Documentation</b><br><b>*(Gwyn Madden, University of Nevada at Las Vegas)</b>  |
| <b>9:00-9:15</b> | <b>The Art and Science of Tattoos on Mummies</b><br><b>*(Heather Gill-Robinson, University of Manitoba)</b>   |
| <b>9:15-9:30</b> | <b>Mummies, the Media and Science: The Unwrapping of an Inca Mummy from Túcume, Peru</b><br><b>(J. Marla Toyne, Tulane University; Andrew J. Nelson, University of Western Ontario; Alfredo Narváez Vargas and Bernarda Delgado Elias, Museo de Túcume)</b> |

## NOTES

## **Programme académique/Academic Programme**

**Friday/Vendredi (9:30am-1:30pm)**

---

### **Session 5**

#### **4-D Paleoanthropology: Applications of Digital Morphometrics, Computer-aided Systematics and Geographical Information Systems Analysis to the Study of Great Ape and Human Origins**

**Présidente/Chair: David R. Begun, University of Toronto**

---

- |                    |   |
|--------------------|---|
| <b>9:30-9:45</b>   | <b>Introductory Remarks</b>   |
| <b>9:45-10:00</b>  | <b>Site Formation and Taphonomy at Çand r: A Geographic Information Systems Approach</b><br>(M. Nargolwalla, University of Toronto and Erksin G le , University of Ankara)  |
| <b>10:00-10:15</b> | <b>The burden of Proof in Hominoid Cladistics: Using Individual Character Consistency Indices as a Phylogenetic Measure of Confidence in Cladistic Analyses of Morphological Characters</b><br>(A.S. Deane and D.R. Begun, University of Toronto) |
| <b>10:15-10:30</b> | <b>Break</b>  |
| <b>10:30-10:45</b> | <b>What, if anything, are <i>Orrorin tugenensis</i> and <i>Sahelanthropus tchadensis</i>? A cladistic approach to the radiation of late Miocene hominids</b><br>(D.R. Begun and A.S. Deane, University of Toronto)                                |
| <b>10:45-11:00</b> | <b>A new morphometric approach to understanding skeletal curvature using Analytical Comparison of Digitized Curvatures (ACDC)</b><br>(A.S. Deane, E.P. Kremer and D.R. Begun, University of Toronto)  |
| <b>11:00-11:15</b> | <b>When is the Absence of Evidence Evidence of Absence? Paleobiogeographic Implications of the Fossil Record at Ngorora</b><br>*(Kaila Folinsbee, University of Toronto)  |
| <b>11:15-11:30</b> | <b>The use of innominate trabecular architecture in reconstructing the positional behaviour of <i>Oreopithecus bamboli</i></b><br>*(T. Kivell, University of Toronto)   |
| <b>11:30-11:45</b> | <b>Human Dental Size Reduction: A Comparison of Middle and Later Stone Age Mandibular Molars</b><br>(Christopher Strong and Susan Pfeiffer, University of Toronto)  |
| <b>11:45-12:00</b> | <b>Paper pulled</b>   |
| <b>12:00-1:30</b>  | <b>Lunch</b>  |

## NOTES

***Programme académique/Academic Programme***  
***Friday/Vendredi (1:30pm-2:45pm)***

---

**Workshop**

**Teaching Physical Anthropology: A Workshop on Teaching Strategies and Tricks of the Trade**

**Anne Keenleyside, Trent University**

Teaching is often a neglected part of what we, as academics, do. As most students don't take anthropology in high school, they are exposed to anthropology for the first time at the university level. Their first exposure to the subject and how it is taught is therefore critical if they are to pursue further studies in the discipline. This workshop will present strategies for teaching physical anthropology. Strategies that can be used for both introductory level courses and upper level courses will be presented and will include activity-based, arts-based, cooperative learning, direct instruction, independent learning, inquiry and research, and critical thinking strategies. Some discussion of Howard Gardner's theory of multiple intelligences and the need to adopt teaching strategies that reflect the different ways in which students learn will be included.



## NOTES

***Programme académique/Academic Programme***  
***Friday/Vendredi 3:00pm-4:30pm***

---

**Session 6**

**Digital Imaging in Bioarchaeology: New Concepts and Approaches**

**Présidente/Chair: R.D. Hoppa, University of Manitoba**

---

- |                  |   |
|------------------|---|
| <b>3:00-3:15</b> | <b>Introductory Remarks</b>   |
| <b>3:15-3:30</b> | <b>Testing Osteometric Applications of 3-D Imaging using the 3D Metrics Flash!Cam</b><br>(R.D. Hoppa, University of Manitoba)   |
| <b>3:30-3:45</b> | <b>Going Digital: Age Estimation from the Pubic Symphysis Using Digital Images</b><br>*(M. Sitchon, University of Manitoba)   |
| <b>3:45-4:00</b> | <b>How 'Handy' was Homo Habilis Anyway? A 3-D Comparative Analysis of the Trapezium</b><br>(M.W. Tocheri, M.W. Marzke, D. Liu, M. Bae, G.P. Jones, R.C. Williams and A. Razdan, Arizona State University) |
| <b>4:00-4:30</b> | <b>3-Dimensional Laser Imaging</b><br>(Susan Dineen and Paul Roy, Arius -3D)  |

## NOTES

***Programme académique/Academic Programme***  
***Saturday/Samedi 8:00am-10:15am***

---

**Session 7**

**Hard Tissue Studies at the Molecular, Microscopic and Chemical Levels**  
**Présidente/Chair: Shelley Saunders, McMaster University**

---

- 8:00-8:15      Introductory Remarks**
- 8:15-8:30      Analysis of Tooth Enamel Phosphate: Reconstructing Place of  
Origin for War of 1812 Combatants**  
**\*(Lisa Blyth, University of Western Ontario)**
- 8:30-8:45      aDNA Success Rates: A Comparison of Tooth and Bone Samples  
from the Same Individuals**  
**\*(Tanya von Hunnius, McMaster Paleogenetics Institute)**
- 8:45-9:00      A Comparison of Histological Age Estimation Methods Using Ribs**  
**\*(Christian Crowder, University of Toronto)**
- 9:00-9:15      A Test of the Revised Frost's 'Rapid Manual Method' for the  
Preparation of Bone Thin Sections**  
**(Patrick Beauchesne and Shelley Saunders, McMaster University)**
- 9:15-9:30      Oxygen Isotopic Composition of Bone Carbonate: An Additional  
Tool to Investigate Weaning in the Maya Postclassic**  
**(Christine White, University of Western Ontario; Jocelyn Williams,  
University of Calgary; and Fred J. Longstaffe, University of Western  
Ontario)**
- 9:30-9:45      The Use of pQCT to Examine Trabecular Microarchitecture in a  
Medieval Archaeological Population**  
**(S.C. Agarwal, McMaster University; X. Banse, Université Catholique de  
Louvain; W. White, Museum of London; M.D. Grynpas, University of  
Toronto and the SLRI of Mount Sinai Hospital; and J-P. Devogelaer,  
Université Catholique de Louvain)**
- 9:45-10:00      On the Right Metacarpal of God: A Pollical Parable of Sinister  
Symmetry, Dexterously Delved**  
**(Richard Lazenby, University of Northern B.C.)**
- 10:00-10:15      Break**

## NOTES

**Programme académique/Academic Programme**  
**Saturday/Samedi (10:15am-1:30pm)**

---

**Session 8**

**Food for Thought: Studies of Diet and Nutrition in Physical Anthropology**

Présidente/Chair: Tina Moffat, McMaster University

---

**10:15-10:30 Introductory Remarks**

**10:30-10:45 Weaning Practices of the Makushi of Guyana and Their Relation to Health and Growth: A Preliminary Assessment of International Recommendations**  
(Jillian Milner; Warren Wilson, University of Calgary)

**10:45-11:00 Concordance Between Dental Pathology and Isotopic Evidence for Weaning**  
(Tracy Prowse, McMaster University)

**11:00-11:15 Biocultural Factors Affecting the Prevalence of Rickets Among the Roman Subadult Population of Isola Sacra Necropolis (1st - 3rd Century AD)**

D<sub>3</sub>:  
liver →  
kidney →  
gut

(Carolann Wood and Shelley Saunders, McMaster University; Luca Bondioli, L. Pigorini National Museum of Prehistory and Ethnography, Rome, Italy; and Roberto Machiarelli, Université de Poitiers)

**11:15-11:30 Breastfeeding in the Time of Great Social Change: A Case study of Gibraltarian Women (1960-1996)**  
(Larry Sawchuk, University of Toronto)

**11:30-11:45 Temporal Trends in Obesity in Canada: An Emerging Epidemic**  
(Peter T. Katzmarzyk, Queen's University) May 8, 2002 StatCan

Can Med Assoc  
webpg.

**11:45-12:00 Beyond Tim Hortons: The Availability and Affordability of Food in Hamilton, Ontario.**  
(Jim Latham and Tina Moffat, McMaster University)

**12:00-1:30 Lunch**



## NOTES

***Programme académique/Academic Programme***  
***Saturday/Samedi (1:30pm-3:15pm)***

---

**Session 9**

**The Contribution, and/or Confusion, of Incorporating More Culturally Sensitive Data Sources with Osteology Research**

**Présidente/Chair: Chris Dudar, Smithsonian Institution**

---

- |                  |   |
|------------------|---|
| <b>1:30-1:45</b> | <b>Introductory Remarks</b>   |
| <b>1:45-2:00</b> | <b>Filling the Gaps: Osteology and Historic Records Collaboration at the Elmbank Cemetery</b><br>Chris Dudar, Smithsonian Institution and Brian Gilchrist, Ontario Genealogical Society)                                    |
| <b>2:00-2:15</b> | <b>Document Dilemmas: Dealing with Contradictions in Historical Bioarchaeological Studies</b><br>(Shawn Phillips, Indiana State University)   |
| <b>2:15-2:30</b> | <b>Dialogues with the Dead: An Osteological Analysis of the Paleodemography and Life History of the 18th and 19th Century Northern Frontier in South Africa</b><br>(Tanya Peckmann, University of Cape Town Medical School) |
| <b>2:30-2:45</b> | <b>Beyond a Diagnosis: A Unique Opportunity to Combine Ancient DNA Analysis and Individual Medical Records to Study a Putative Case of Tuberculosis</b><br>*(Jodi Lynn Barta, McMaster University)                          |
| <b>2:45-3:00</b> | <b>Private Voices and Public Records: Using Historical Documents and Osteology to Reconstruct Colonial Life in the Caribbean</b><br>*(Tamara Varney, University of Calgary)   |
| <b>3:00-3:15</b> | <b>Break</b>  |

## NOTES

**Programme académique/Academic Programme**  
**Friday/Vendredi 3:15pm-5:15pm**

---

**Session 10**

**Primate Behaviour**

Présidente/Chair: Anne Zeller (University of Waterloo)

---

- 3:15-3:30**      **Introductory Remarks**  
(Frances Burton, University of Toronto)
- 3:30-3:45**      **Group Size and Social Structure of a Previously Unstudied Population of Black Howlers**  
(Andrea Faulkner and Mary S.M. Pavelka, University of Calgary)
- 3:45-4:00**      **Howlers (*Alouatta palliata*) on the North Coast Honduras**  
\*(Kymberley A. Snarr, University of Toronto)
- 4:00-4:15**      **Seasonally Variable Fission-Fusion Social Organization in the Black Lemu (*Eulemur macaco macaco*)**  
(Ian C. Colquhoun, University of Western Ontario and McMaster University)
- 4:15-4:30**      **Population Reduction and Social Disorganization in Black Howlers (*Alouatta pigra*) Following a Hurricane**  
(Laura McKenzie and Mary S.M. Pavelka, University of Calgary)
- 4:30-4:45**      **Flexibility in Residence Pattern in Primates that "should be" Female-resident; What Mechanisms can we Invoke?**  
(Pascale Sicotte, University of Calgary)
- 4:45-5:00**      **A Case Study of Male-takeover and Male Provocation Among the Geoffroy's Pied Colobus (*Colobus vellerosus*) at Boabeng-Fiema, Ghana**  
(Tania L. Saj, and Pascale Sicotte, University of Calgary)
- 5:00-5:15**      **Behavioural Variability between Captive and Wild *Macaca fascicularis***  
(Anne Zeller, University of Waterloo)
- 5:15-5:30**      **Discussant**

## Posters

---

**Ancient DNA Diagnosis of Canine Tuberculosis**

*(Rhonda R. Bathurst and Jodi Lynn Barta, McMaster University)*

**Early Dentistry or Dental Defect: Enigmatic Molar Crown Morphology in Three Boreal Forest Sites**

*(Todd Garlie, University of Winnipeg; Christopher Meiklejohn, University of Winnipeg and University of Manitoba; Deborah C. Merrett and Christopher L.B. Lavelle, University of Manitoba; Denise Enns, University of Alberta; and Kevin Brownlee, University of Manitoba and Historic Resources Manitoba)*

**Reading Writing and Anthropology: Results of a Survey on the Teaching of Anthropology to Ontario Elementary and Secondary School Students**

*(Jennifer A. Johnson, University of Toronto)*

**A Mortuary Enigma at Ancient Mendes, Egypt**

*(Nancy C. Lovell, University of Alberta)*

**Who's Who at Calakmul? A mtDNA Feasibility Study of Skeletal Remains from an Ancient Population of Campeche, Mexico**

*(Paul Luukkonen, University of Toronto; Vera Tiesler-Blos, Autonomous University of Yucatan; Arlene Lahti, Carney Matheson and J.E. Molto, Lakehead University)*

**Quantification of Bone Mineral Content in Archaeological Bone**

*(Jan, McEwan, Simon Mays and Terry Riauka, University of Alberta)*

**Patient Satisfaction and Confidence in Public Health Care, Republic of Trinidad and Tobago**

*(Alanna Rudzik, University of Toronto)*

**Age-Related Changes to the Intervertebral Discs of the Human Sacrum**

*(Matt Skinner, George Washington University)*

**An Intra-Bone Analysis of Nitrogen Isotope Ratios in Subadult Long Bones: The Effects of Differential Bone Turnover and Growth**

*(Andrea L. Waters, University of Calgary)*

**Hunter's Brother: A Preliminary Analysis**

*(Dedrie White and Kevin Brownlee, University of Manitoba)*

## **SPONSORS**

**WE WOULD LIKE TO THANK OUR CONFERENCE SPONSORS  
FOR THEIR SUPPORT**

**Archaeological Survey of Canada  
Ottawa Police Services  
Ontario Provincial Police  
Canadian Museum of Nature  
Parks Canada  
Canadian Museum of Civilization  
Waveland Press  
Carolina Press  
Cambridge University Press  
The University of Utah Press  
Paleo-Tech Concepts**



## THE CONFERENCE AT A GLANCE

Wednesday 23rd October	Thursday 24th October	Friday 5th October	Saturday 26th October
	8:00-10:15 ~ <i>Personal Identification in Forensic Anthropology</i>	8:00-9:30 ~ <i>Mummy Studies</i>	8:00-10:00 ~ <i>Hard Tissue Studies at the Molecular, Microscopic and Chemical</i>
		9:30-10:15 ~ <i>4-D Paleoanthropology: Applications of Digital Morphometrics, Computer-aided Systematics and Geographical Information Systems Analysis to the Study of Great Ape and</i>	
	10:15-10:30 ~ <i>Break</i>	10:15-10:30 ~ <i>Break</i>	10:00-10:15 ~ <i>Break</i>
	10:30-12:00 ~ <i>Contributed Papers</i>	10:30-12:00 ~ <i>4-D Paleoanthropology: Applications of Digital Morphometrics, Computer-aided Systematics and Geographical Information Systems Analysis to the Study of Great Ape and</i>	10:15-12:00 ~ <i>Food for Thought: Studies of Diet and Nutrition in Physical Anthropology</i>
	12:00-1:30 ~ <i>Lunch</i>	12:00-1:30 ~ <i>Lunch</i>	12:00-1:30 ~ <i>Lunch</i>
	1:30-3:15 ~ <i>Contributed Papers</i>	1:30-2:45 ~ <i>Workshop - Teaching Physical Anthropology: A Workshop on Teaching Strategies and Tricks of the Trade</i>	1:30-3:00 ~ <i>The Contribution, and/or Confusion, of Incorporating More Culturally Sensitive Data Sources with</i>
	3:15-3:30 ~ <i>Break</i>	2:45-3:00 ~ <i>Break</i>	3:00-3:15 ~ <i>Break</i>
4:00-8:00 ~ <i>Registration</i>	3:30-6:00 ~ <i>Doing Biocultural Anthropology</i>	3:00-4:30 ~ <i>Digital Imaging in Bioarchaeology: New Concepts and</i>	3:15-5:30 ~ <i>Primate Behaviour</i>
		4:30-6:00 ~ <i>Business Meeting</i>	
	7:30-10:00 ~ <i>Reception</i>	7:00-11:00 ~ <i>Banquet</i>	

### LOCATIONS

**Thursday Morning** - Sessions - Ballroom 'A' - Lower Level; Posters/Displays - Chaudière Rm - Conference Level  
**Thursday Afternoon** - Sessions - Joliet Rm - Conference Level; Posters/Displays - Chaudière Rm - Conference Level  
**Friday** - Sessions/Posters/Displays - Ballroom 'A' - Lower Level  
**Saturday** - Sessions/Posters/Displays - Ballroom 'A' - Lower Level